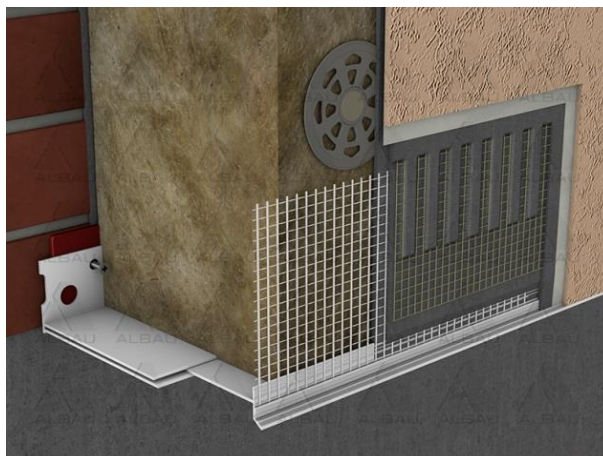
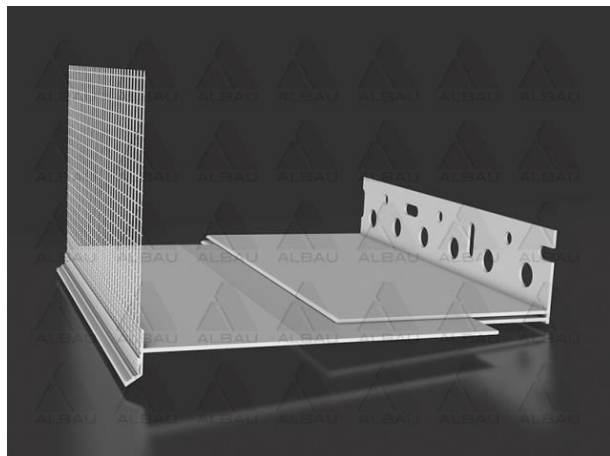

**EB-PVC-VARIO / Base bead set**

**Application** Base profile set VARIO is used for horizontal set-up of thermal insulating plates in the insulation system ETICS. Profile set VARIO guaranteeing the precise shaping of the base of the building, with no risk of cracking or mechanical damage and secure assembly of insulating plates. The dimensions of the two-piece system can be adjusted to the width of the insulation board by retracting increased strength of the connection to the rendering system, using glass fibre mesh. It prevents thermal bridges and leads purpose fully the rain water away from the system. Glass fibre mesh meet the ETAG 004 requirements.

**Comply with the ETICS insulation system****Advantages:**

- structurally and visually perfect seating of thermal insulation boards
- increased mechanical resistance during transportation and handling unlike aluminium profiles
- maintenance of heat loss resulting from thermal bridges, unlike similar systems made from steel or aluminium
- the dimensions of the two-piece system can be adjusted to the width of the insulation board by retracting
- reduction of the number of items on stock thanks to the dimensional adaptability of the two-piece solution
- simple level seating of thermal insulation boards
- simple access to fixing holes and elimination to the rendering system using integrated glass-fibre mesh, and subsequent prevention of cracks
- improved runoff of rainwater and prevention of water being absorbed beneath the insulating board as a result of the extended drip nose element
- easy to cut and subsequently handle from the aspect of work

**MADE IN EUROPE**

Distributor: Ltd "Albau" – Ritvari, Rumbula, Stopinu district, LV-2121, Latvia

Reg.No. - 40103561205

[www.albau.eu](http://www.albau.eu)[www.xbau.eu](http://www.xbau.eu)

**Technical information:**

Product code	EAN	Thickness of insulation	Material	Length	Package
ALB-EB-PVC140-20	4751023402468	100-140 mm	PVC	2,0 m	10 pcs.
ALB-EB-PVC180-20	4751023402475	140-180 mm	PVC	2,0 m	10 pcs.
ALB-EB-PVC220-20	4751023402482	180-220 mm	PVC	2.0 m	10 pcs.

**Installation tips:**

- 1) Level any unevenness using plastic spacers ALB-EB-DIST
- 2) We recommend that the base beads are attached using fixings at intervals of 30-40 cm
- 3) Leave dilation gap of approx. 1-2 mm between the individual base beads
- 4) We recommend that the beads be cut diagonally at corners
- 5) After the first row of thermal insulation board is seated, slide the wall base bead for the second part of the system into the bottom groove - the slide-on bead with drip nose-and butt it to the insulation board
- 6) Incorporate the glass-fibre mesh into applicer render
- 7) When completing the base layer apply the glass-fibre mesh up to the edge of the drip nose profile of the slide-on bead
- 8) Pay attention when cutting to avoid damaging the profile or the glass-fibre mesh
- 9) Be careful when hammering in the pins because the properties of the PVH bead material changes if temperatures are below 5°C



**Storage:**

A horizontal storage position is recommended. The profiles need to be stored in a dry place the temperature range of -5°C to +40°C. Maximum recommended storage time is 24 months.

**MADE IN EUROPE**

Distributor: Ltd "Albau" – Ritvari, Rumbula, Stopinu district, LV-2121, Latvia

Reg.No. - 40103561205



[www.albau.eu](http://www.albau.eu)



[www.xbau.eu](http://www.xbau.eu)

